

# DWG U-1030-XX-XX

REV	REVISION DESCRIPTION	DATE	BY
1	transferred to CAD	01-29-07	DAM

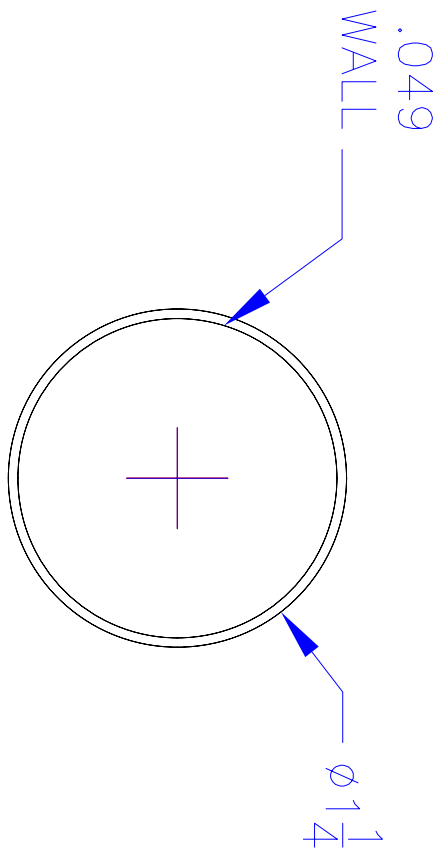

- 1  $1 \frac{1}{4}$ " X .049 WALL STAINLESS STEEL SHOWER ROD
- PART NUMBER CODES U-1030-XX (TUBE LENGTH)  
U-1030-XX-XX (FINISH CODE)
- SATIN & BRIGHT STAINLESS AVAILABLE
- PC (POWDER COAT -SPECIFY COLOR

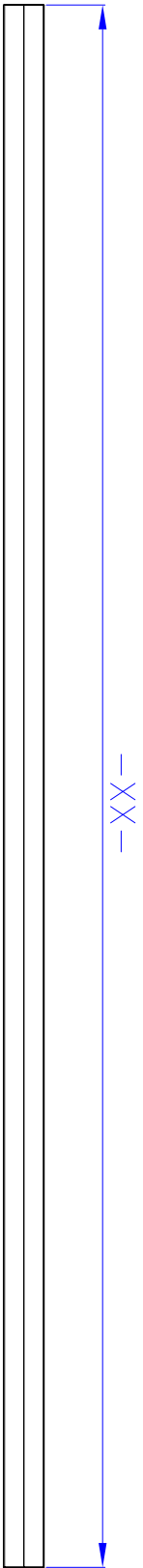

ITEM	PART No.	DESCRIPTION	QTY.	Drawn	DATE	10-10-08	Dim are in Inches Tolerances: (unless Otherwise Specified) Fractional: $\pm \frac{1}{16}$ " Angular: XX: +/- 0.015 XXX: +/- 0.010	U-1030-XX-XX 1 $1 \frac{1}{4}$ " X .049 WALL STAINLESS SHOWER ROD
				Checked	Eng. Appr.			

Brey-Krause Mfg.  
1209 West Lehigh Street  
Bethlehem, PA 18018

SIZE	DWG NO.
A	XXXXXXXXXX.dwg
SCALE	SHEET 1 OF 1
REV	1